

Construction Options

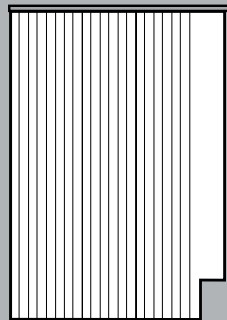

23 | 21 | 19 | 17 | 15 | 13 | 11 | 9 | 7 | 5 |
24' 22 20 18 16 14 12 10 8 6 4"

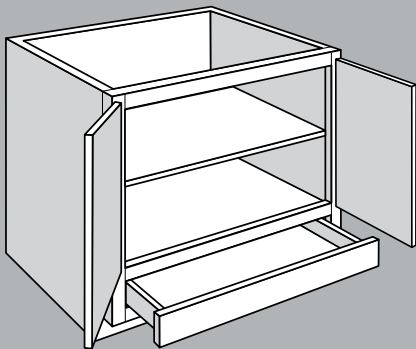
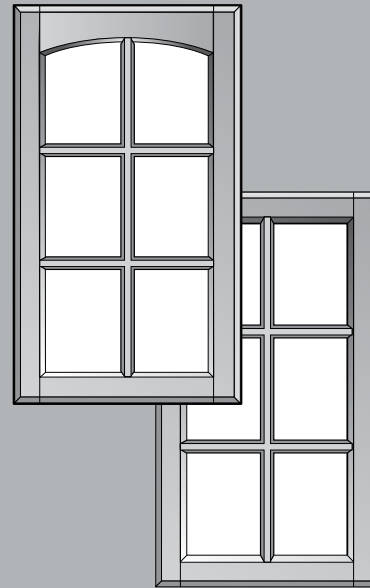
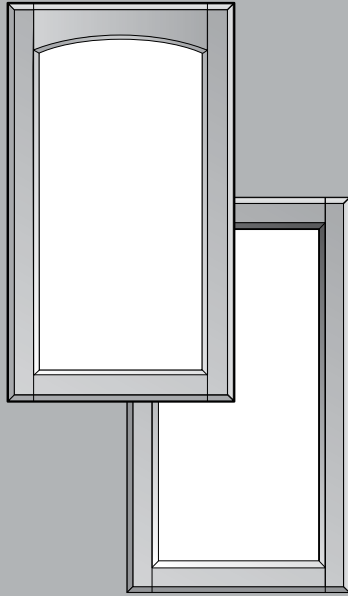
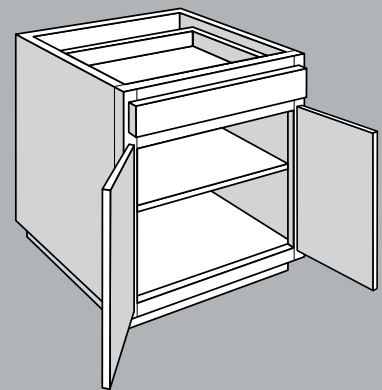

CONSTRUCTION OPTIONS	CODE
All Plywood Construction Option	APC
Cabinet Front Only Option	CFO
CushionClose® Package	(Pre-selected in 20-20)
Furniture Ends Option	FE
Increased Depth Cabinet Option	ID
Inverted Frame Cabinet Option	IF
Matching Interior Cabinet Option	MI
Plywood Ends Option	PE
Premium Finish Cabinet Options	Maple Auburn Glaze Maple Mocha Glaze Painted Boulder Painted Cashmere Painted Ember Glaze Painted Harbor Painted Hazelnut Glaze Painted Linen Painted Pewter Glaze Painted Silk Painted Stone
Recessed Toe Kick Option	RTKL (Recessed Toe Kick Left) RTKR (Recessed Toe Kick Right) RTKB (Recessed Toe Kick Both)
Reduced Depth Cabinet Option	RD
Void Door Wall Cabinet Option - NO Molding	VDO-DFH (Drilled For Hinges)
Void Door Wall Cabinet Options –INCLUDING Molding	VDO-SAM (Shaker Accent Molding) VDO-SBAM (Single Bead Accent Molding) VDO-TBAM (Triple Bead Accent Molding)
Remove CushionClose for Doors	XCDO
Remove CushionClose for Drawers	XCDW
Remove CushionClose for Roll Out Accessories	XCRO

SPECIALTY DOOR (SD) OPTIONS	CODE
Aluminum Frame Door - Brushed Aluminum	AFBA
Aluminum Frame Door - Vintage Iron	AFVI
Horizontal Frame Door	HFD
Mullion Frame Door	MFD
Open Frame Door	OFD
Prairie Frame Door	PFD

1. When the option appears, it indicates the construction option is available for all SKU's in the product box unless otherwise noted.

In this product box, all SKUs (B36, B39, B42 and B48) are available with Cabinet Front Only, Inverted Frame Cabinet, Reduced Depth Cabinet and Recessed Toe Kick options.

Base Cabinet	
2 Doors, 2 Drawers	
B36	APC
B39	CFO
B42	FE
B48	IF
	PE
	RD
	RTK

2. When a square ■ is included within the icon and next to the SKU, it indicates the construction option is ONLY available for that specific SKU.

In this product box, only the W930, W1230, W1530, W1830, W2130 and W2430 are available with the Void Door or Matching Interior Options as the Specialty Door (SD) cabinets feature Matching Interior standard.

Wall Cabinet	
30" High, 1 Door	
■ W930	APC
■ W1230	CFO
■ W1530	FE
■ W1830	ID
■ W2130	■ MI
■ W2430	PE
	RD
	■ VDO
W1230 SD	
W1530 SD	
W1830 SD	
W2130 SD	

3. When a construction icon is not listed, it indicates the construction option is NOT available for any SKU in the product box.

In this product box, none of the SKUs are available with Matching Interior or Void Door Options as these icons are not listed.

Base Cabinet	
1 Door, 1 Drawer	
B12	APC
B15	CFO
B18	FE
B21	IF
B24	PE
	RD
	RTK

All Plywood Construction Option

APC

All Plywood Construction Option includes:

- ½" plywood sides, floors and cabinet tops
- ¾" plywood shelves with edge banding
- ⅛" plywood captured back
- ½" plywood inset toe kick
- ½" plywood corner blocks (excluding BEA/BER/BPP/BPPUS/BTDP/BSS/CAR/CBS/CSB cabinets)

Notes:

- Exterior sides finished to match specific cabinet color.
- Plywood will be visible from top and bottom of side panels.
- Available for individual cabinets or entire kitchen.
- Available for all door styles.
- All door styles feature standard interior sides of natural woodgrain finish.
- **Cannot be ordered with Plywood Ends Option.**
- Available with Matching Interior Option. Please refer to the product SKU box for details .
- Toe kick support blocks are not plywood.
- Roll out accessories and drawer inserts will not feature All Plywood Construction.
- All Plywood Construction refers to the cabinet box components and shelving as detailed above (certain parts and accessories are not available with this construction option).
- Plywood can consist of a combination of veneer and medium density fiberboard (MDF) layers to achieve superior product stability and finish quality. Plywood components meet the ANSI/Decorative Hardwoods Association hardwood and decorative plywood standards (www.decorativehardwoods.org).

Plywood Ends Option

PE

Plywood Ends Option includes:

- ½" plywood cabinet sides

Notes:

- Exterior sides finished to match specific cabinet color.
- Plywood will be visible from top and bottom of sidepanels.
- Available for individual cabinets or entire kitchen.
- All door styles feature standard interior sides of natural woodgrain finish.
- **Cannot be ordered with All Plywood Construction Option or Furniture Ends Option.**
- Available with Matching Interior Cabinet Option. Please refer to the product SKU box for details .
- Plywood Ends refers to the cabinet box side panels as detailed above (certain parts and accessories are not available with this construction option).
- Plywood can consist of a combination of veneer and medium density fiberboard (MDF) layers to achieve superior product stability and finish quality. Plywood components meet the ANSI/Decorative Hardwoods Association hardwood and decorative plywood standards (www.decorativehardwoods.org).

Cabinet Front Only Option

CFO

The Cabinet Front Only Option is available for most cabinets with a frame (see individual cabinet specifications for icon verifying this option availability).

Notes:

- This option consists of the cabinet front face frame, door(s), drawer front(s) and hinges.
- Toe kicks are not included.
- This option is only available for cabinets without accessories.

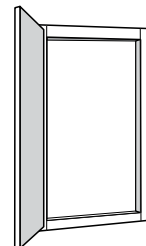
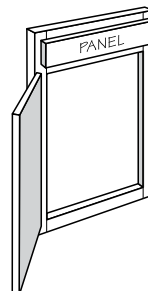

	Standard Construction	Plywood Ends Option (PE)	All Plywood Construction Option (APC)
Cabinet Sides	½" Engineered Wood with TuffTech finish	½" Plywood Exterior	½" Plywood Exterior
Cabinet Floor	½" Engineered Wood	½" Engineered Wood	½" Plywood
Cabinet Top (Wall Cabinets Only)	½" Engineered Wood	½" Engineered Wood	½" Plywood
Cabinet Back	⅛" Hardboard Substrate captured	⅛" Hardboard Substrate captured	⅛" Plywood captured
Face Frame	Double-Doweled ¾" x 1 ⅝" Hardwood	Double-Doweled ¾" x 1 ⅝" Hardwood	Double-Doweled ¾" x 1 ⅝" Hardwood
Inset Toe Kick	½" Engineered Wood	½" Engineered Wood	½" Plywood
Corner Blocks (excluding BER/BSS/CAR/CBS/CSB cabinets)	½" Engineered Wood	½" Engineered Wood	½" Plywood
Shelves	¾" Engineered Wood with Edge Banding	¾" Engineered Wood with Edge Banding	¾" Plywood with Edge Banding
Wall Cabinet Hanging Rails	½" Engineered Wood Top and Bottom Rails	½" Engineered Wood Top and Bottom Rails	½" Plywood Top and Bottom Rails
Base Cabinet Hanging Rails	¾" Hardwood Top Rail ½" Engineered Wood Bottom Rail	¾" Hardwood Top Rail ½" Engineered Wood Bottom Rail	¾" Hardwood Top Rail ½" Plywood Bottom Rail
Standard Interior	Natural Woodgrain TuffTech	Natural Woodgrain TuffTech Tops, Bottoms, Shelves and Back with Natural Woodgrain Side Panels	Natural Woodgrain
Specialty Door cabinets or cabinets that feature Matching Interior Cabinet Option (N/A Maple Natural)	TuffTech Finish	TuffTech Finish Tops, Bottoms, Shelves and Back with Plywood Side Panels finished to match cabinet exterior	Plywood finished to match cabinet exterior

Inverted Frame Cabinet Option

IF

The Inverted Frame Cabinet Option is available for most Standard Base Cabinets, Base Cabinets with Factory Installed Wastebasket(s) and Base Pot & Pan Organizer Cabinets (see individual cabinet specifications for IF icon verifying this option availability).

Notes:

- Drawer(s) below full cabinet floor.
- Available with All Plywood Construction (APC), Furniture Ends (FE), Plywood Ends (PE), Reduced Depth (RD) and Recessed Toe Kick (RTK) options.
- Back is not predrilled for Deep Roll Out Trays (DROT's).

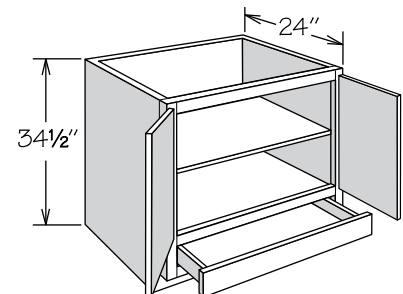
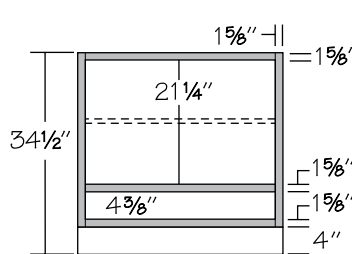

Furniture Ends Option

FE

Furniture Ends Option includes:

- ¾" plywood cabinet sides

Notes:

- Exterior sides feature plywood finished to match specific cabinet color.
- Plywood will be visible from top and bottom of side panels.
- Available on individual cabinets except BEA24 FH Base End Angle and WEA12 Wall End Angle cabinets.
- When the Furniture Ends Option is selected, both side panels convert to ¾" plywood sides except BEA12 FH Base End Angle cabinet which converts the 12" side panel only.
- Available for all door styles.
- All door styles feature standard interior sides of natural woodgrain finish with plywood exterior.
- May be combined with standard construction, All Plywood Construction and all other construction options except the Plywood Ends Option.
- End panels are not required for exposed ends of cabinets with the Furniture Ends Option.
- End panels are not required for installation of Decorator Matching Doors to cabinets with the Furniture Ends Option.
- Cabinet Angle Molding (CAM8) cannot be used with cabinets with the Furniture Ends Option.
- Sink Front Return (SFR R/L) with the Furniture Ends Option will include a rabbeted front edge.
- A seam will be visible between stacked cabinets and on 93" and 96" Tall cabinets between the toe kick box and the cabinet. Recommendations to conceal this seam:
 - Use decorative molding (e.g., BM8 WD Batten Molding or OGP8 Ogee Pilaster Molding)
 - Use a Column Filler or Wood Tall End Panel
- Cannot be ordered with Plywood Ends Option.
- Plywood can consist of a combination of veneer and MDF layers to achieve superior product stability and finish quality. Plywood components meet the ANSI/Decorative Hardwoods Association hardwood and decorative plywood standards (www.decorativehardwoodsassociation.org).

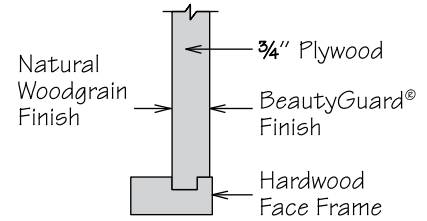

Void Door Cabinet Option

VDO

The Void Door Cabinet Option is available for most wall cabinets. All void door cabinets ship without doors or hinges – center stiles and adjustable shelves will remain. Cabinet frames are pre-drilled for door hinges. All void door wall top hinge cabinets ship without door, lid stays and hinges.

Refer to the descriptions below to select the correct option for your layout:

- VDO-DFH (Drilled For Hinges)
- VDO-SBAM (Single Bead Accent Molding)
- VDO-TBAM (Triple Bead Accent Molding)
- VDO-SAM (Shaker Accent Molding)

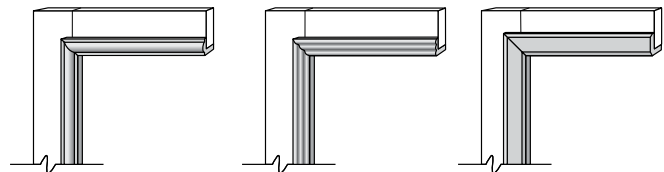

Notes for VDO with Molding:

- Can be used to create decorative open cabinets
- Decorative Accent Moldings will conceal hinge holes
- Molding is to be cut and field installed at the job site
- When matching interior is desired, the Matching Interior Cabinet Option must be selected

VDO-SBAM
Single Bead Accent
Molding

VDO-TBAM
Triple Bead Accent
Molding

VDO-SAM
Shaker Accent
Molding

Premium Finish Cabinet Option

Our premium finish colors accentuate the detailing and textures of the cabinetry.

Options include:

- Luxurious paint that emphasizes lines and rich detail with an inviting texture.
- Glazes that settle into the recesses, corners and grooves to add definition and a distinctive patina.
- Glazes are applied over either a wood stain or painted base.

Premium Finish	Base Finish Details	Glaze Details	Available Collections
Maple Auburn Glaze	Maple Cognac	Dark Brown	All Maple door styles, excluding Del Ray, Hanover, Leesburg, Leesburg w/ DFO, Reading and Reading w/ DFO
Maple Mocha Glaze	Maple Spice	Dark Brown	All Maple door styles, excluding Del Ray, Hanover, Leesburg, Leesburg w/ DFO, Reading and Reading w/ DFO
Painted Ember Glaze	Painted Harbor	Warm Brown Gray	Ashland, Brookland, Charlottesville, MacArthur, Newport, Olmsted, Portola, Portola w/ DFO and Savannah
Painted Hazelnut Glaze	Painted Silk	Deep Brown	Ashland, Brookland, Charlottesville, MacArthur, Newport, Olmsted, Portola, Portola w/ DFO and Savannah
Painted Pewter Glaze	Painted Linen	Dark Gray	Ashland, Brookland, Charlottesville, MacArthur, Newport, Olmsted, Portola, Portola w/ DFO and Savannah

Premium Finish	Finish Details	Available Collections
Painted Boulder	Dark Gray Paint	Ashland, Brookland, Charlottesville, Del Ray, Leesburg, Leesburg w/ DFO, MacArthur, Newport, Olmsted, Portola, Portola w/ DFO, Reading, Reading w/ DFO, Savannah and Shorebrook
Painted Cashmere	Creamy Taupe Paint	Ashland, Brookland, Charlottesville, Del Ray, Leesburg, Leesburg w/ DFO, MacArthur, Newport, Olmsted, Portola, Portola w/ DFO, Reading, Reading w/ DFO, Savannah and Shorebrook
Painted Harbor	Soft Warm Gray Paint	Ashland, Brookland, Charlottesville, Del Ray, Leesburg, Leesburg w/ DFO, MacArthur, Newport, Olmsted, Portola, Portola w/ DFO, Reading, Reading w/ DFO, Savannah and Shorebrook
Painted Linen	Crisp White Paint	Ashland, Brookland, Charlottesville, Del Ray, Leesburg, Leesburg w/ DFO, MacArthur, Newport, Olmsted, Portola, Portola w/ DFO, Reading, Reading w/ DFO, Savannah and Shorebrook
Painted Silk	Warm White Paint	Ashland, Brookland, Charlottesville, Del Ray, Leesburg, Leesburg w/ DFO, MacArthur, Newport, Olmsted, Portola, Portola w/ DFO, Reading, Reading w/ DFO, Savannah and Shorebrook
Painted Stone	Medium Cool Gray Paint	Ashland, Brookland, Charlottesville, Del Ray, Leesburg, Leesburg w/ DFO, MacArthur, Newport, Olmsted, Portola, Portola w/ DFO, Reading, Reading w/ DFO, Savannah and Shorebrook

Reduced Depth Cabinet Option

RD

The Reduced Depth Cabinet Option should be used when ordering less than standard depth cabinets. Reduced Depth cabinets are available in 1" reductions; minimum cabinet depth is 4". Vanity and Desk cabinets will reduce to standard Reduced Depth increments (i.e. Vanity cabinets with RD-20 will measure 20" in depth).

Orders specifying Reduced Depth Option must show the total cabinet depth.

Example: Cabinet: B24

Option: RD-17 (RD – Reduce to 17" Deep)

Notes:

- There is a potential tipping hazard for Reduced Depth Cabinets until they are mounted to a wall.
- Peninsula Base cabinets reduced to 11" or less will not have an inset toe kick.
- Adjustable shelves are reduced in 1" increments to match Reduced Depth Option selected on cabinet(s).
- Adding the Reduced Depth Cabinet Option does not remove adjustable shelves (where applicable).
- All cabinets reduced to 5" or less will not have an inset toe kick.
- All cabinets reduced to 8" or less are not available with the Recessed Toe Kick Option.
- Reduced depth minimum for Wall Top Hinge cabinets is 8".
- Reduced depth minimum for Base End Angle (BEA12FH) cabinets is 18".
- Reduced depth minimum for Kneehole Drawer cabinets is 12".
- Reduced depth minimum for Two Drawer Base cabinets is 21".
- Reduced depth minimum for 24" Deep Furniture Drawer cabinets is 13".

Reduced Depth	Drawer Depth Base & 24" Deep Desk Cabinets	Drawer Depth Vanity & 21" Deep Desk Cabinets	Deep Roll Out Tray Depth
RD-23	18"	—	18"
RD-22	18"	—	18"
RD-21	18"	—	18"
RD-20	15"	15"	15"
RD-19	15"	15"	15"
RD-18	15"	15"	15"
RD-17	12"	12"	12"
RD-16	12"	12"	12"
RD-15	12"	12"	12"
RD-14	9"	9"	9"
RD-13	9"	9"	9"
RD-12	9"	9"	9"
RD-11 to RD-4	No Drawer	No Drawer	Not Available

Increased Depth Cabinet Option

ID

The Increased Depth Cabinet Option is available for most Wall cabinets up to 36" wide (refer to individual cabinet specifications for ID icon verifying this option availability) and all Bookshelves available in 1" increments. Maximum cabinet depth is 24".

Orders specifying Increased Depth Option must show the total cabinet depth.

Example: Cabinet: W1530
Option: ID-14 (ID – Increase to 14" Deep)

Notes:

Wall Cabinets:

- Adjustable shelves are increased in 1" increments to match Increased Depth Option selected on cabinets.
- Increased Depth Wall cabinets up to and including 18" deep can be mounted using standard installation procedures.
- Wall cabinets increased to more than 18" deep must be stacked, floor mounted or installed over a refrigerator.
- All Increased Depth cabinets must be securely attached in one of the following combinations: to studs in back wall and both sides OR to studs in back wall, one side and top (e.g., two adjacent cabinets or one adjacent cabinet and a wall).

Peninsula Wall (PW) and Blind Peninsula Wall (BLPW) Cabinets:

- Increased Depth PW and BLPW cabinets up to 15" deep may be mounted at ceiling height using standard installation procedures.
- PW and BLPW cabinets increased to more than 15" deep must be stacked or floor mounted.
- When mounting cabinet at ceiling height, the cabinet must be securely attached to the ceiling rafters and to at least one other properly mounted cabinet or studs in wall.
- Additional 2" x 4" bracing may be required above ceiling if cabinets are not located directly below a rafter.
- Mount cabinet to the ceiling using mounting screws of sufficient length to go through ceiling treatment and into the rafter at least 1". Screws must be installed at both front and back of cabinet on 16" centers (maximum span), with at least four screws per cabinet.

Recessed Toe Kick Option

RTK

The Recessed Toe Kick Option is available on most Base, Desk and Vanity base cabinetry (refer to individual cabinet specifications for RTK verifying this option availability). When the Recessed Toe Kick Option is selected, left, right or both must be specified.

Notes:

- Recommended for cabinets at the end of a run, especially in island and peninsula designs.
- Recessed side(s) are constructed of 1/2" thick unfinished plywood and are recessed 3 1/2" to match front of cabinet.
- **Recessed Toe Kick box is not flush on non-recessed side.**
- Blind Corner Base cabinets (BLB_) are only available with the Recessed Toe Kick Both Option (RTKB).
- BEA24 FH and BEA12 FH Base End Angle, BPP9 Base Pantry Pull Out, BPPUS9 Base Pantry Pull Out Utensil Storage, BTDP9 Base Tray Divider Pull Out, TB9 and TB9 TDS cabinets are not available with the Recessed Toe Kick Both Option (RTKB).
- Not available for cabinets with the Reduced Depth Cabinet Option of RD-8 and lower.
- Not available for Peninsula Base cabinets with the Reduced Depth Cabinet Option of RD-11 and lower.
- For Peninsula Base cabinets, the drawer side indicates the front of the cabinet.
- Peninsula Base cabinets ordered with Recessed Toe Kick Option must be secured to the floor through the cabinet bottom into bracing secured to the floor.
- Base Toe Kick (BTK8) required for front and any exposed side(s).

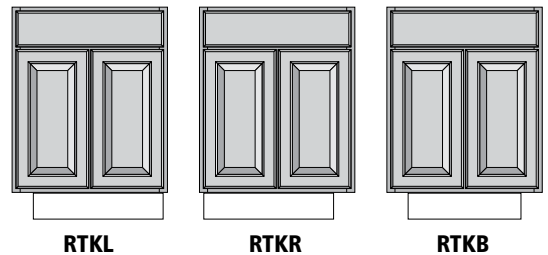

CushionClose Package

The CushionClose package includes CushionClose for Drawers (including full-height pull outs), CushionClose for Doors and CushionClose for Roll Out Accessories and is pre-selected in 20-20.

Notes:

- CushionClose for Drawers and CushionClose for Roll Out Accessories provide all of the features and benefits of the standard Full-Access Hidden Glides System with the addition of an integrated slow-close mechanism that reduces slamming and noise.
- CushionClose for Doors features a slow closing mechanism that helps reduce slams and noise.
- Decorative hardware strongly recommended.
- CushionClose is not available for BER_, BSDC6, BSS_, CAR_, MC_, TV_30, WER_ and WTH_.

Remove CushionClose for Doors

XCDO

The Remove CushionClose for Doors option is available for most cabinets with a door.

Notes:

- This option removes CushionClose for Doors.

Remove CushionClose for Drawers

XCDW

The Remove CushionClose for Drawers option is available for all cabinets with a drawer.

Notes:

- Removes CushionClose for Drawers and replaces glides with Full-Access Hidden Glides.
- Wastebasket cabinets will be replaced with heavy-duty non-CushionClose glides.
- CushionClose cannot be removed from 2 Drawer Base cabinets.

Remove CushionClose Roll Out Accessories

XCRO

The Remove CushionClose for Roll Out Accessories is available for most cabinets.

Notes:

- This option removes CushionClose from Roll Out Accessories and replaces glides with side-mounted glides.

Matching Interior Cabinet Option

MI

The Matching Interior Cabinet Option is available for Wall cabinets (with exceptions noted below), Utility cabinets, Vanity Linen cabinets and Refrigerator Return Panels. This option matches the cabinet's interior, top and bottom to that of the cabinet's exterior sides.

Notes:

- Available for Wall, Utility and Vanity Linen cabinets with the All Plywood Construction Option (APC), Plywood Ends Option (PE), Furniture Ends Option (FE), Reduced Depth Cabinet Option (RD), Increased Depth Cabinet Option (ID) or standard construction.
- American Woodmark strongly recommends using the All Plywood Construction Option (APC) when Matching Interior (MI) is selected.
- Standard construction cabinetry with the Matching Interior Cabinet Option features two-sided engineered wood TuffTech finish side panels finished to match cabinet exterior.
- Cabinetry with the All Plywood Construction Option (APC), Furniture Ends Option (FE) or Plywood Ends Option (PE) features plywood side panels finished to match cabinet exterior.
- Matching Interior cabinetry with the All Plywood Construction Option features $\frac{3}{4}$ " plywood shelves finished to match cabinet exterior.
- Recommended for cabinets with the Void Door Cabinet Option (VDO).
- Not available for any Wall cabinet with a standard Matching Interior (i.e. Specialty Door cabinets, Bookshelves, Microwave Cabinets, etc.).
- All finished surfaces of the Wall, Utility and Vanity Linen cabinets will be color matched including shelves, back, interior and exterior of returns, top and bottom, Corner Wall back post and back side of Peninsula Wall face frames.
- Interior accessories in Matching Interior cabinets (i.e., Spice Rack Kit, Deep Roll Out Trays, Pantry Swing Out Kit) will remain natural finish.

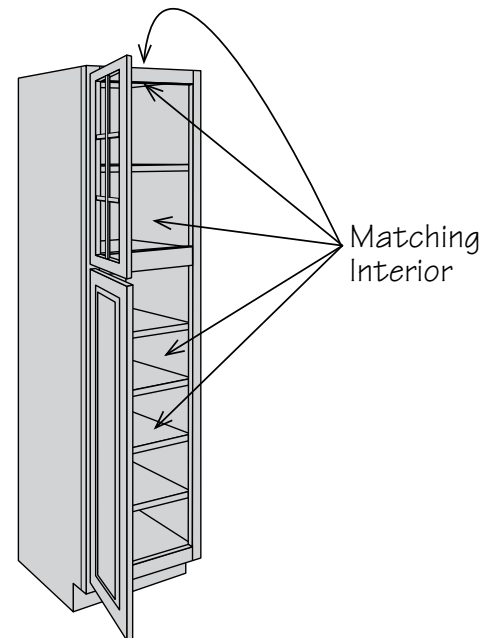
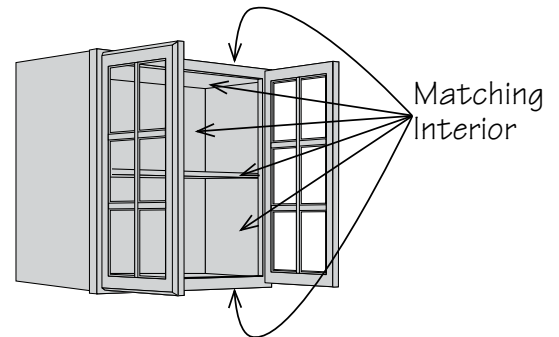

Specialty Door Options

Specialty Door cabinets are available for most Wall, Utility and Vanity Linen cabinet sizes. All Specialty Door cabinets include Matching Interior as standard (see page 57 for Matching Interior construction) and require one of the specialty door options below. Specialty Door options for Utility and Vanity Linen cabinets apply to top door(s) only.

Open Frame Door (OFD) notes:

- Features door frame only with no mullions or center panel.
- Decorative Glass Inserts and appropriate glass clips are shipped separately from the cabinet for field installation - see pages 66-69 for available Glass Inserts.
- See page 60 for door style profiles.

Mullion Frame Door (MFD) notes:

- Features grid-style mullions.
- Not available for Wall Top Hinge cabinets.
- Decorative Glass Inserts and appropriate glass clips are shipped separately from the cabinet for field installation - see pages 66-69 for available Glass Inserts.
- See pages 61-63 for door style profiles.

Horizontal Frame Door (HFD) notes:

- Features horizontal mullions.
- Not available for Wall Top Hinge cabinets.
- Not available for 12" high cabinets.
- Decorative Glass Inserts and appropriate glass clips are shipped separately from the cabinet for field installation - see pages 66-69 for available Glass Inserts.
- See page 64 for door style profiles.

Prairie Frame Door (PFD) notes:

- Craftsman-inspired mullions featuring 9 lites for all available door sizes.
- Corner lites will be a 1½" square for all available door sizes.
- Not available for Wall Top Hinge cabinets.
- 12" High Specialty Door cabinets (SD) with the Prairie Frame Door Option (PFD) only available for Leesburg, Leesburg w/ DFO, or Shorebrook (excluding Thermofoil) door styles.
- Decorative Glass Inserts and appropriate glass clips are shipped separately from the cabinet for field installation - see pages 66-69 for available Glass Inserts.
- See page 63 for door style profiles.

Aluminum Frame Door (AFBA/AFVI) notes:

- Available for Full Overlay door styles only.
- Cathedral door styles default to square.
- Door stiles and rails are 2⅛" mitered aluminum with Brushed Aluminum (AFBA) or Vintage Iron (AFVI) finish.
- Glass panels are factory installed and non-removable - see page 65 for frame and glass combinations.
- Glass panels are tempered for safety with etched finish.

Specialty Door Availability by Size

Door Width	Cabinet Door Height													
	12" High Wall	15" High Wall	18" High Wall	21" High Wall	24" High Wall	27" High Wall	30" High Wall	36" High Wall	39" High Wall	42" High Wall	84" High Utility or Vanity Linen	90" High Utility	93" High Utility	96" High Utility
12" Wide			●		●		●	●	●	●	●	●	●	●
13" Wide			●		●		●	●	●	●				
15" Wide	◆	●	●	●	●	●	●	●	●	●	●	●	●	●
16" Wide	◆	●	●	●	●		●	●	●	●				
18" Wide	◆	●	●	●	●		●	●	●	●	●	●	●	●
19" Wide	◆	●	●		●		●							
21" Wide			●		●		●	●	●	●				
30" Wide		■	■											
36" Wide		■	■											

- Available with all Specialty Door Options
- Wall Top Hinge cabinets only - not available with HFD, MFD or PFD Options
- ◆ HFD Option not available, PFD Option only available for Leesburg, Leesburg w/ DFO, or Shorebrook (excluding Thermofoil) door styles

Specialty Door Availability by Door Style

Door Style	OFD	MFD	HFD	PFD	AF_
Ashland	●	●			
Atherton	●				●
Brookland	●	●			●
Charlottesville	●	●			●
Del Ray	●		●		●
Glen Ellen	●				
Hanover	●	●	●	●	●
Hanover Thermofoil	●		●		●
Leesburg	●	●	●	●	●
Leesburg w/ DFO	●	●	●	●	●
MacArthur	●				●
Newport	●	●			
Olmsted	●	●			
Portland	●	●			
Portola	●	●			●
Portola w/ DFO	●	●			●
Reading	●	●	●	●	●
Reading w/ DFO	●	●	●	●	●
San Mateo	●				
Savannah	●	●			●
Shorebrook	●	●	●	●	●
Shorebrook Thermofoil	●	●			●

Open Frame Specialty Doors

OFD

Profiles for:

- Ashland
- Charlottesville
- Newport
- Olmsted
- Portland
- Portola
- Portola w/ DFO

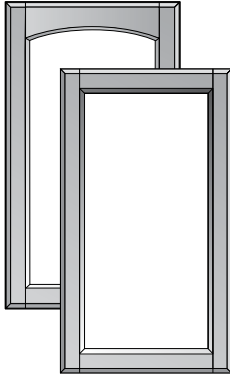

Profile for:

- Leesburg
- Leesburg w/ DFO
- San Mateo
- Shorebrook

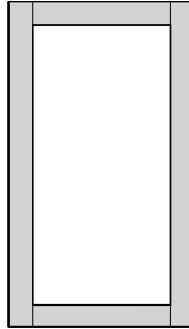

Profile for:

- Hanover
- Reading
- Reading w/ DFO

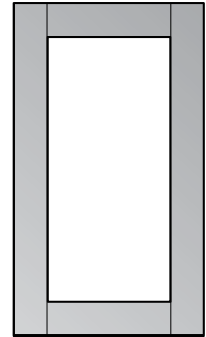

Profile for:

- Del Ray

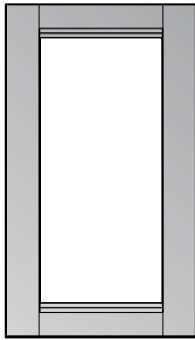

Profile for:

- Glen Ellen

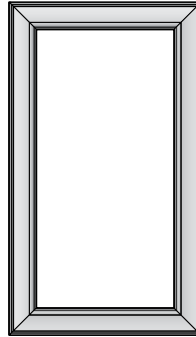

Profile for:

- Atherton

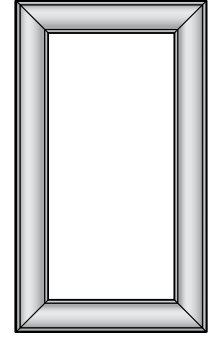

Profile for:

- Brookland

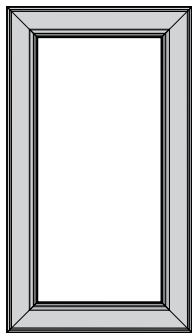

Profile for:

- Savannah

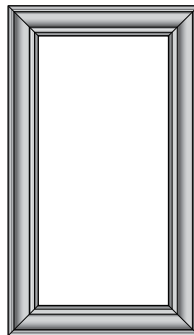

Profile for:

- MacArthur

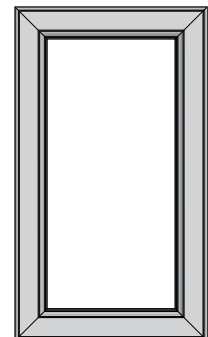

Mullion Frame Specialty Doors

MFD

Profiles for:

- Ashland
- Charlottesville
- Newport
- Olmsted
- Portland
- Portola
- Portola w/ DFO

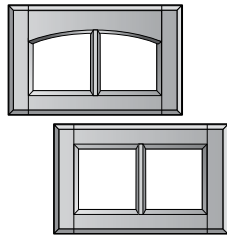

12" High Wall Cabinet

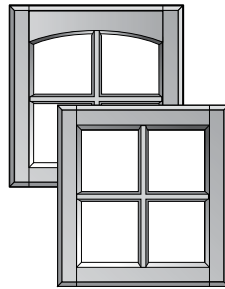

15", 18", 21",
24" or 27"
High Wall Cabinet

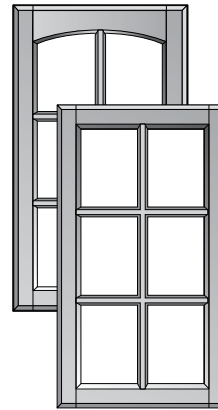

30" or 36" High Wall Cabinet
84" or 90" High Utility Cabinet
84" High Vanity Linen Cabinet

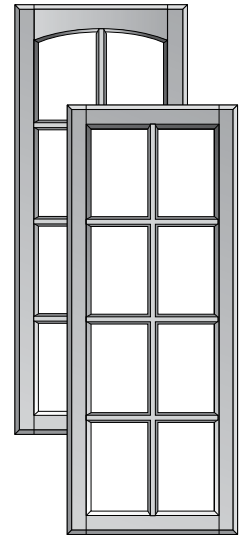

39" or 42" High Wall Cabinet
93" or 96" High Utility Cabinet

Profile for:

- Leesburg
- Leesburg w/ DFO
- Shorebrook

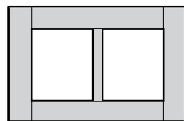

12" High Wall Cabinet

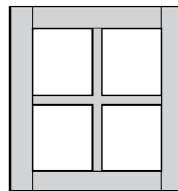

15", 18", 21",
24" or 27"
High Wall Cabinet

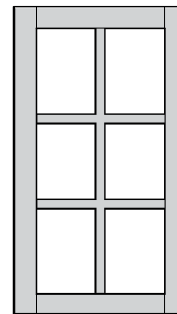

30" or 36" High Wall Cabinet
84" or 90" High Utility Cabinet
84" High Vanity Linen Cabinet

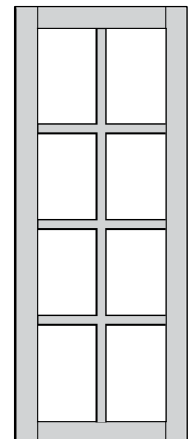

39" or 42" High Wall Cabinet
93" or 96" High Utility Cabinet

Mullion Frame Specialty Doors

MFD

Profile for:

- Savannah

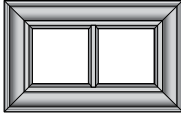

12" High Wall Cabinet

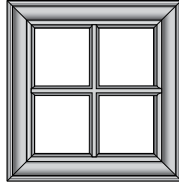

15", 18", 21",
24" or 27"
High Wall Cabinet

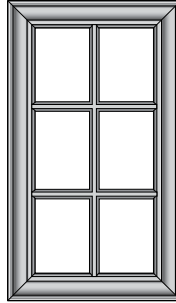

30" or 36" High Wall Cabinet
84" or 90" High Utility Cabinet
84" High Vanity Linen Cabinet

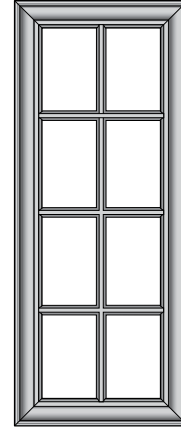

39" or 42" High Wall Cabinet
93" or 96" High Utility Cabinet

Profile for:

- Brookland

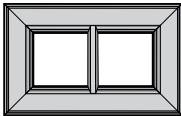

12" High Wall Cabinet

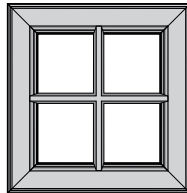

15", 18", 21",
24" or 27"
High Wall Cabinet

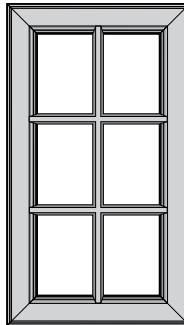

30" or 36" High Wall Cabinet
84" or 90" High Utility Cabinet
84" High Vanity Linen Cabinet

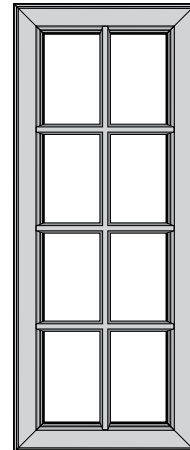

39" or 42" High Wall Cabinet
93" or 96" High Utility Cabinet

Mullion Frame Specialty Doors

MFD

Profile for:

- Hanover*
- Reading
- Reading w/ DFO



12" High Wall Cabinet

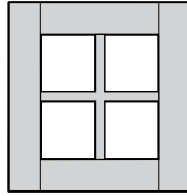

15", 18", 21",
24" or 27"
High Wall Cabinet

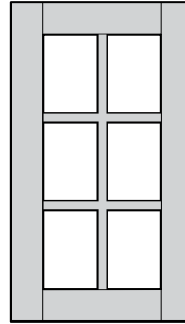

30" or 36" High Wall Cabinet
84" or 90" High Utility Cabinet
84" High Vanity Linen Cabinet

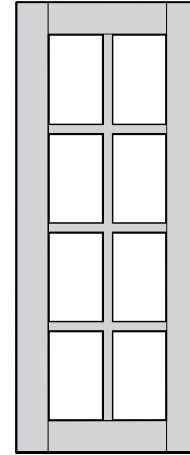

39" or 42" High Wall Cabinet
93" or 96" High Utility Cabinet

*Not available for Hanover Thermofoil

Prairie Frame Specialty Doors

PFD

Profile for:

- Leesburg
- Leesburg w/ DFO
- Shorebrook*

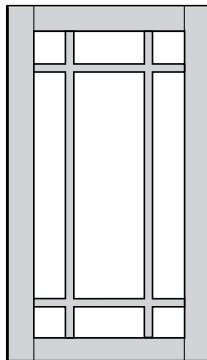

*Not available for Shorebrook Thermofoil

Profile for*:

- Hanover†
- Reading
- Reading w/ DFO

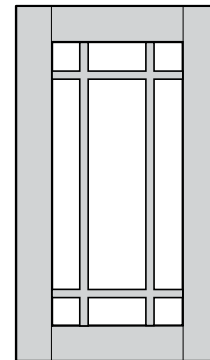

*PFD option not available for 12" High Wall Cabinets

†Not available for Hanover Thermofoil

Horizontal Frame Specialty Doors

HFD

Profile for:

- Leesburg
- Leesburg w/ DFO
- Shorebrook*

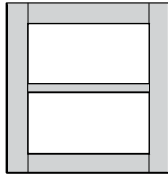

15", 18", 21",
24" or 27"
High Wall Cabinet

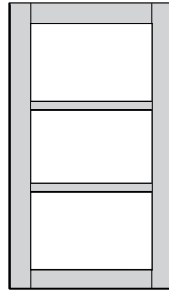

30" or 36" High Wall Cabinet
84" or 90" High Utility Cabinet
84" High Vanity Linen Cabinet

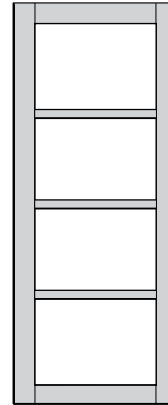

39" or 42" High Wall Cabinet
93" or 96" High Utility Cabinet

*Not available for Shorebrook Thermofoil

Profile for:

- Hanover
- Reading
- Reading w/ DFO

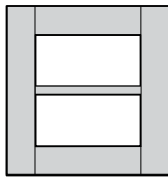

15", 18", 21",
24" or 27"
High Wall Cabinet

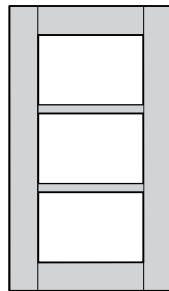

30" or 36" High Wall Cabinet
84" or 90" High Utility Cabinet
84" High Vanity Linen Cabinet

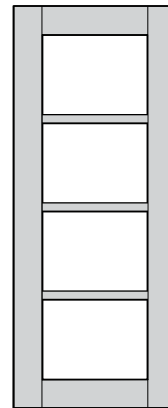

39" or 42" High Wall Cabinet
93" or 96" High Utility Cabinet

Profile for:

- Del Ray

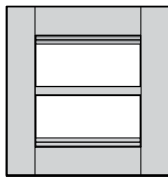

15", 18", 21",
24" or 27"
High Wall Cabinet

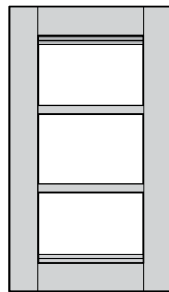

30" or 36" High Wall Cabinet
84" or 90" High Utility Cabinet
84" High Vanity Linen Cabinet

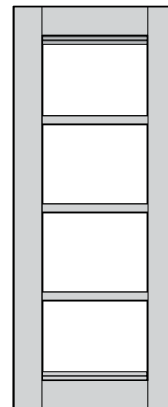

39" or 42" High Wall Cabinet
93" or 96" High Utility Cabinet

Aluminum Frame Specialty Doors - Brushed Aluminum

AFBA

Profile for:

- Atherton
- Brookland
- Charlottesville
- Del Ray
- Hanover
- Leesburg
- Leesburg w/ DFO
- MacArthur
- Portola
- Portola w/ DFO
- Reading
- Reading w/ DFO
- Savannah
- Shorebrook

Brushed Aluminum with Frosted Glass



AFBA Frosted

Brushed Aluminum with Frosted Ash Glass



AFBA Frosted Ash

Brushed Aluminum with Woven Glass



AFBA Woven

Aluminum Frame Specialty Doors - Vintage Iron

AFVI

Profile for:

- Atherton
- Brookland
- Charlottesville
- Del Ray
- Hanover
- Leesburg
- Leesburg w/ DFO
- MacArthur
- Portola
- Portola w/ DFO
- Reading
- Reading w/ DFO
- Savannah
- Shorebrook

Vintage Iron with Frosted Glass



AFVI Frosted

Vintage Iron with Frosted Umber Glass



AFVI Frosted Umber

Vintage Iron with Havana Glass



AFVI Havana

Afton Glass



Antiqued Afton Glass



Clear Glass



OFD

- $\frac{5}{16}$ " overall thickness
- Afton has a clear glass design using zinc caming with clear beveled diamonds
- Antiqued Afton has a clear glass design using bronze patina caming with clear beveled diamonds
- Features one row of diamonds for 12"-18" high doors and two rows for 21" or higher doors
- Full Overlay (excluding 2 $\frac{1}{4}$ " stiles and rails) and Partial Overlay door styles feature one column of diamonds for 12"-15" wide doors and two columns for 16" or wider doors
- Full Overlay door styles with 2 $\frac{1}{4}$ " stiles and rails feature one column of diamonds for 12"-13" wide doors and two columns for 15" or wider doors
- Includes appropriate Decorative Glass Clips
- Not available for Wall Top Hinge cabinets
- Order as DGI-__AFTON or ANTIQUED AFTON, refer to Parts Directory for nomenclature and dimensions

HFD

MFD

OFD

PFD

- $\frac{1}{8}$ " thick panel
- Clear glass
- Tempered safety glass
- Includes appropriate Decorative Glass Clips
- Order as DGI-__CLEAR, refer to Parts Directory for nomenclature and dimensions

Fincastle Glass



Antiqued Fincastle Glass



Derbyshire Seeded Glass



OFD

- $\frac{5}{16}$ " overall thickness
- Fincastle has a clear glass design using zinc caming
- Antiqued Fincastle has a clear glass design using bronze patina caming
- Not available for 12" high doors
- Includes appropriate Decorative Glass Clips
- Not available for Wall Top Hinge cabinets
- All sizes features 3 vertical caming lines, spacing will vary according to glass width
- Order as DGI-__FINCASTLE or ANTIQUED FINCASTLE, refer to Parts Directory for nomenclature and dimensions

HFD

MFD

OFD

PFD

- $\frac{5}{16}$ " thick panel
- Clear seeded glass
- Laminated safety glass
- Includes appropriate Decorative Glass Clips
- Order as DGI-__DERBYSHIRE, refer to Parts Directory for nomenclature and dimensions

Frosted Glass



HFD
MFD
OFD
PFD

- 1/8" thick panel
- Frosted glass with etched finish
- Tempered safety glass
- Includes appropriate Decorative Glass Clips
- Order as DGI-__FROSTED, refer to Parts Directory for nomenclature and dimensions

Frosted Ash Glass

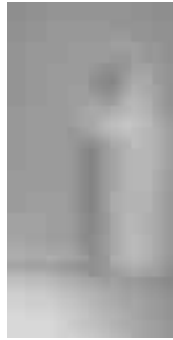

HFD
MFD
OFD
PFD

- 1/8" thick panel
- Gray tinted glass
- Tint is manufactured in material - not a film
- Tempered safety glass
- Includes appropriate Decorative Glass Clips
- Order as DGI-__FROSTED ASH, refer to Parts Directory for nomenclature and dimensions

Frosted Umber Glass



HFD
MFD
OFD
PFD

- 1/8" thick panel
- Bronze tinted glass
- Tint is manufactured in material - not a film
- Tempered safety glass
- Includes appropriate Decorative Glass Clips
- Order as DGI-__FROSTED UMBER, refer to Parts Directory for nomenclature and dimensions

Havana Glass



HFD
MFD
OFD
PFD

- 1/8" thick panel
- Bronze tinted glass with a two-sided acid etched pattern - one horizontal and one vertical
- Tempered safety glass
- Includes appropriate Decorative Glass Clips
- Order as DGI-__HAVANA, refer to Parts Directory for nomenclature and dimensions

Impression Glass



HFD
MFD
OFD
PFD

- 1/8" thick panel
- Sculptural glass
- Tempered safety glass
- Includes appropriate Decorative Glass Clips
- Order as DGI-__IMPRESSION, refer to Parts Directory for nomenclature and dimensions

Lucent Glass



HFD
MFD
OFD
PFD

- 1/8" thick panel
- Sculptural glass
- Tempered safety glass
- Includes appropriate Decorative Glass Clips
- Order as DGI-__LUCENT, refer to Parts Directory for nomenclature and dimensions

Meredith Glass



OFD

- ¼" overall thickness (⅛" beveled edge thickness)
- Clear glass design with 1 ¼" wide beveled edges
- Tempered safety glass
- Includes appropriate Decorative Glass Clips
- Order as DGI-__MEREDITH, refer to Parts Directory for nomenclature and dimensions

Mirror Glass



HFD

MFD

OFD

PFD

- ¼" thick panel
- Laminated safety glass
- White vinyl in between glass layers
- Includes appropriate Decorative Glass Clips
- Order as DGI-__MIRROR, refer to Parts Directory for nomenclature and dimensions

Radiance Glass



HFD

MFD

OFD

PFD

- ¼" thick panel
- Clear glass with randomized bronze/copper fabric
- Randomized patterns may result in inherent variations between adjacent pieces
- Laminated safety glass
- Includes appropriate Decorative Glass Clips
- Order as DGI-__RADIANCE, refer to Parts Directory for nomenclature and dimensions

Ribbed Glass



HFD

MFD

OFD

PFD

- ¼" thick panel
- Clear ribbed glass
- Tempered safety glass
- Includes appropriate Decorative Glass Clips
- Not available for Wall Top Hinge cabinets
- Order as DGI-__RIBBED, refer to Parts Directory for nomenclature and dimensions

Twilight Glass



HFD

MFD

OFD

PFD

- ¼" thick panel
- Laminated safety glass
- Clear glass with randomized silver fabric
- Randomized patterns may result in inherent variations between adjacent pieces
- Includes appropriate Decorative Glass Clips
- Order as DGI-__TWILIGHT, refer to Parts Directory for nomenclature and dimensions

Woven Glass



HFD

MFD

OFD

PFD

- ¼" thick panel
- Acid-etched fabric pattern
- Low-iron glass
- Tempered safety glass
- Includes appropriate Decorative Glass Clips
- Order as DGI-__WOVEN, refer to Parts Directory for nomenclature and dimensions

Prepped for Glass

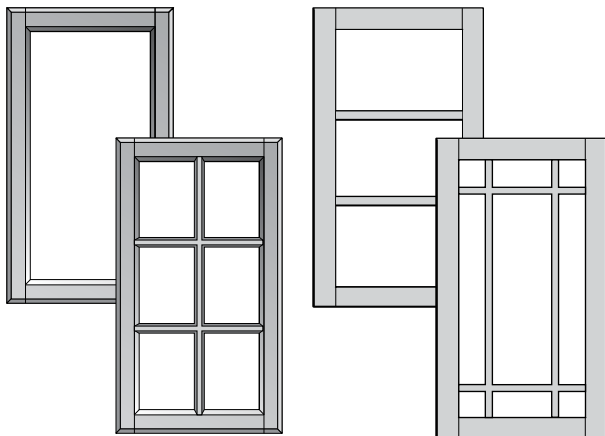

HFD
MFD
OFD
PFD

- For customer installed inserts up to 5/16" thick
- Refer to pages 60-64 for door style specific profile
- Decorative Glass Clips not included - order separately

Decorative Glass Clips

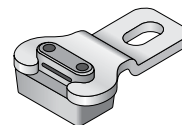

CLIP DGI 1/8

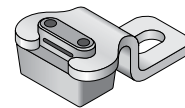

CLIP DGI 1/4

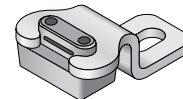

CLIP DGI 5/16

CLIP DGI 1/8
CLIP DGI 1/4
CLIP DGI 5/16

- For installation of Decorative Glass Inserts
- Order one bag (six clips) per door
- See chart below for correct glass pairing

Glass Insert	CLIP DGI 1/8	CLIP DGI 1/4	CLIP DGI 5/16
Afton			•
Antiqued Afton			•
Antiqued Fincastle			•
Clear	•		
Derbyshire			•
Fincastle			•
Frosted	•		
Frosted Ash	•		
Frosted Umber	•		
Havana	•		
Impression	•		
Lucent	•		
Meredith	•		
Mirror		•	
Radiance		•	
Ribbed	•		
Twilight		•	
Woven	•		

